

**DESIGN REPORT**

- Legend:**
- City Boundary
  - Proposed Development Boundary
  - Proposed Road Development
  - Proposed Temporary Road Diversion
  - Permanent Road Diversion
  - Permanent Road Closure
  - Temporary Road Closure

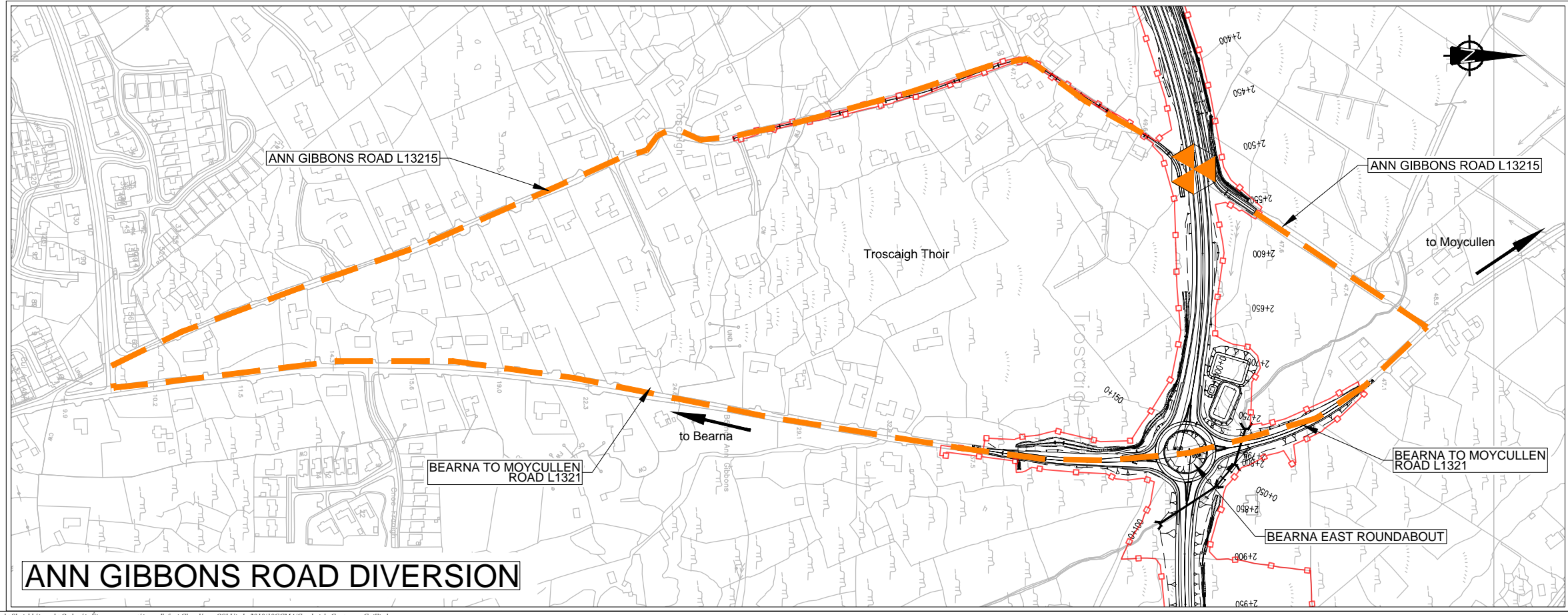
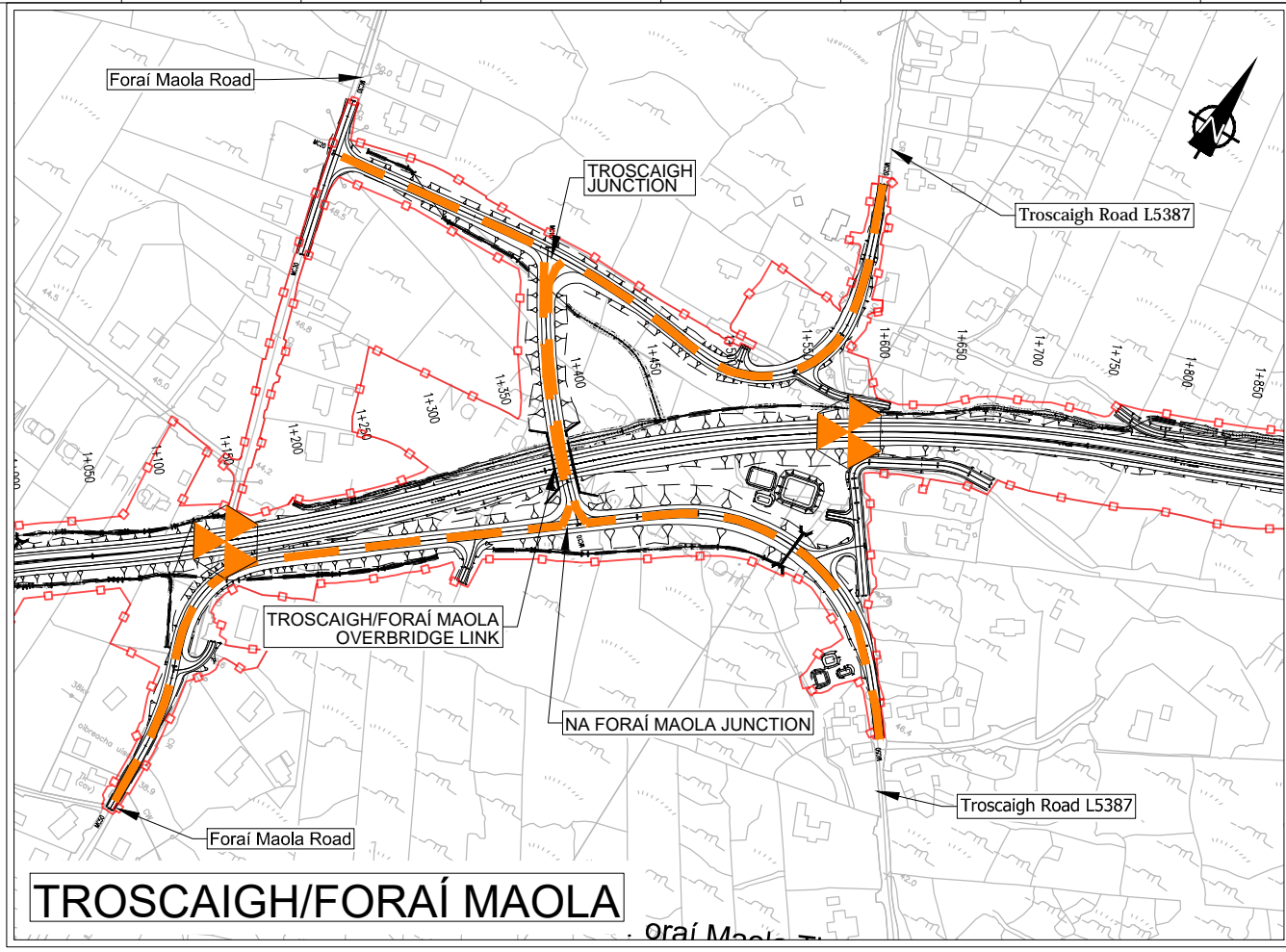

Sin díreámh tá sonraíocht Shuirbhíreachtí Ordánais Éireann arna aistriúgeadh fós Cheadúnas OSI Uimh. 2010/18CCMA/Comhairle Contae na Gaillimhe. Sírúisinn aistriúgeadh neamhdídaraithe cóipeacht Shuirbhíreachtí Ordánais Éireann agus Rialtas na hÉireann. © Suirbhíreacht Ordánais Éireann, 2010.

© Suirbhíreacht Ordánais Éireann. Gach ceart ar chosaint. Uimhir cheadúnais 2010/18CCMA/Comhairle Contae na Gaillimhe.

Includes Ordnance Survey Ireland data reproduced under OSI Licence number 2010/18CCMA/Galway County Council. Unauthorised reproduction infringes Ordnance Survey Ireland and Government of Ireland copyright. © Ordnance Survey Ireland, 2010.

© Ordnance Survey Ireland. All rights reserved. Licence number 2010/18CCMA/Galway County Council.

**Clients**

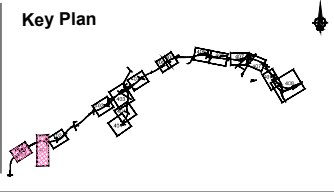

**Consultant**

Corporate House  
City East Business Park  
Ballybrit, Galway, Ireland.

Tel +353 (0)91 460675  
www.N6GalwayCity.ie  
www.arup.ie

**Job Title**  
N6 Galway City Ring Road

**Scale**  
1:5000 @ A3

**Date:**  
February 2018

Issue	Date	By	Chkd	Appd
I1	22/02/2018	AG	GOD	MH

**Drawing Title**  
Traffic Diversions & Road Closures

**Sheet 1 of 8**

**For Information**

Job No: **233985**  
Drawing No: **GCOB-100-D-401**  
Issue: **11**

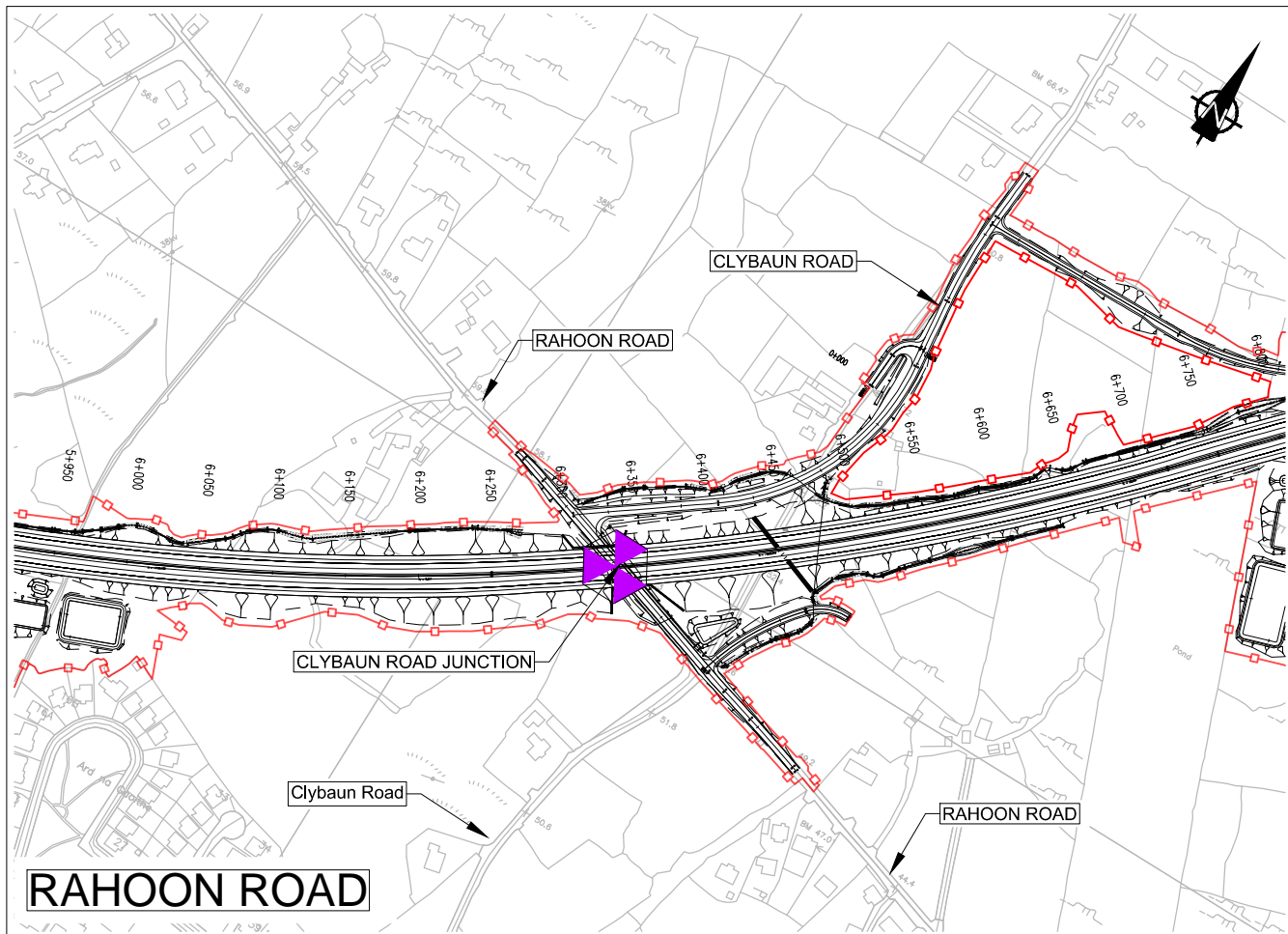
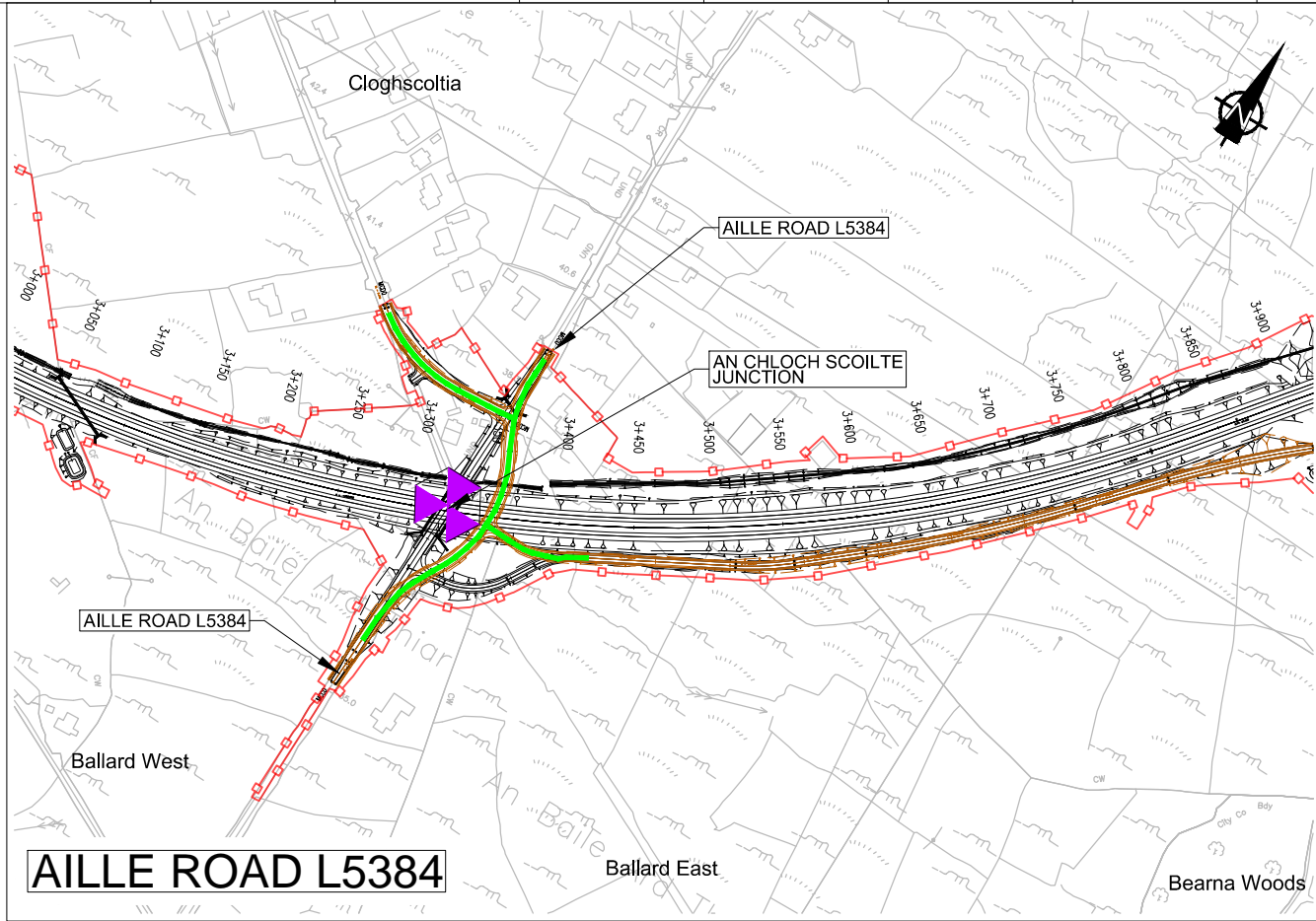

**DESIGN REPORT**

- Legend:**
- City Boundary
  - Proposed Development Boundary
  - Proposed Road Development
  - Proposed Temporary Road Diversion
  - Permanent Road Diversion
  - Permanent Road Closure
  - Temporary Road Closure

Sin áireamh tá sonraíocht Shuirbhíreacht Ordánais Éireann arna atáirgeadh fust Cheadúnas OSI Uimh. 2010/18CCMA/Comhairle Contae na Gaillimhe. Sírtaíonn atáirgeadh neamhdaraithe cóipeacht Shuirbhíreacht Ordánais Éireann agus Rialtas na hÉireann. © Suirbhíreacht Ordánais Éireann, 2010.

© Suirbhíreacht Ordánais Éireann. Gach ceart ar chosaint. Uimhir cheadúnais 2010/18CCMA/Comhairle Contae na Gaillimhe.

Includes Ordnance Survey Ireland data reproduced under OSI Licence number 2010/18CCMA/Galway County Council. Unauthorised reproduction infringes Ordnance Survey Ireland and Government of Ireland copyright. © Ordnance Survey Ireland, 2010.

© Ordnance Survey Ireland. All rights reserved. Licence number 2010/18CCMA/Galway County Council.

**Clients**

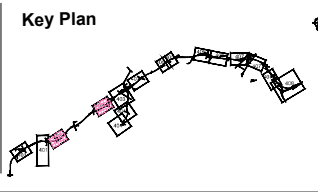

**Consultant**

Corporate House  
City East Business Park  
Ballybrit, Galway, Ireland.

Tel +353 (0)91 460675  
www.N6GalwayCity.ie  
www.arup.ie

**Job Title**  
N6 Galway City Ring Road

**Scale**  
1:5000 @ A3

**Date:**  
February 2018

Issue	Date	By	Chkd	Appd
I1	22/02/2018	AG	GOD	MH

**Drawing Title**  
Traffic Diversions & Road Closures

**Sheet 2 of 8**

**For Information**

Job No	Drawing No	Issue
233985	GCOB-100-D-402	11

**DESIGN REPORT**

- Legend:**
- City Boundary
  - Proposed Development Boundary
  - Proposed Road Development
  - Proposed Temporary Road Diversion
  - Permanent Road Diversion
  - Permanent Road Closure
  - Temporary Road Closure

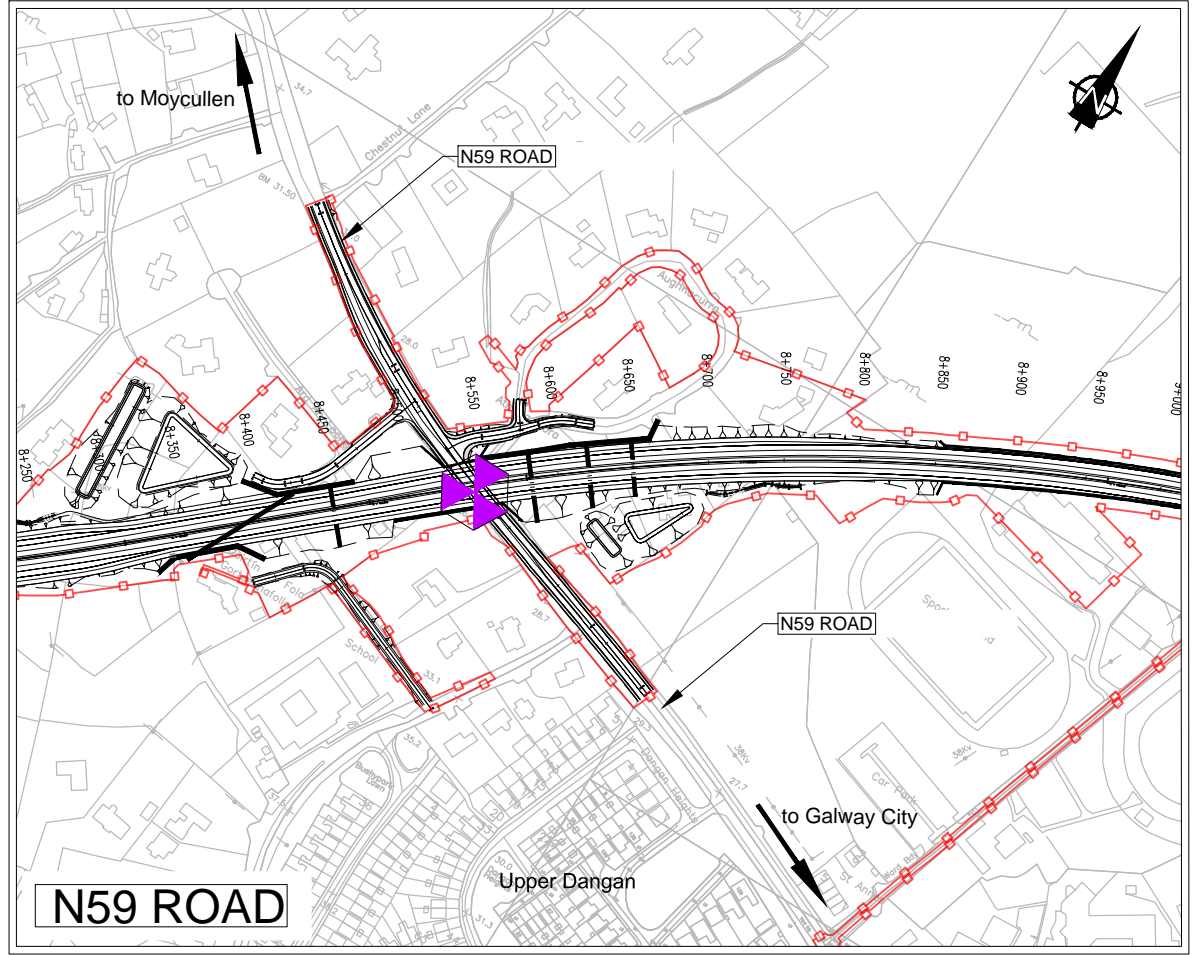
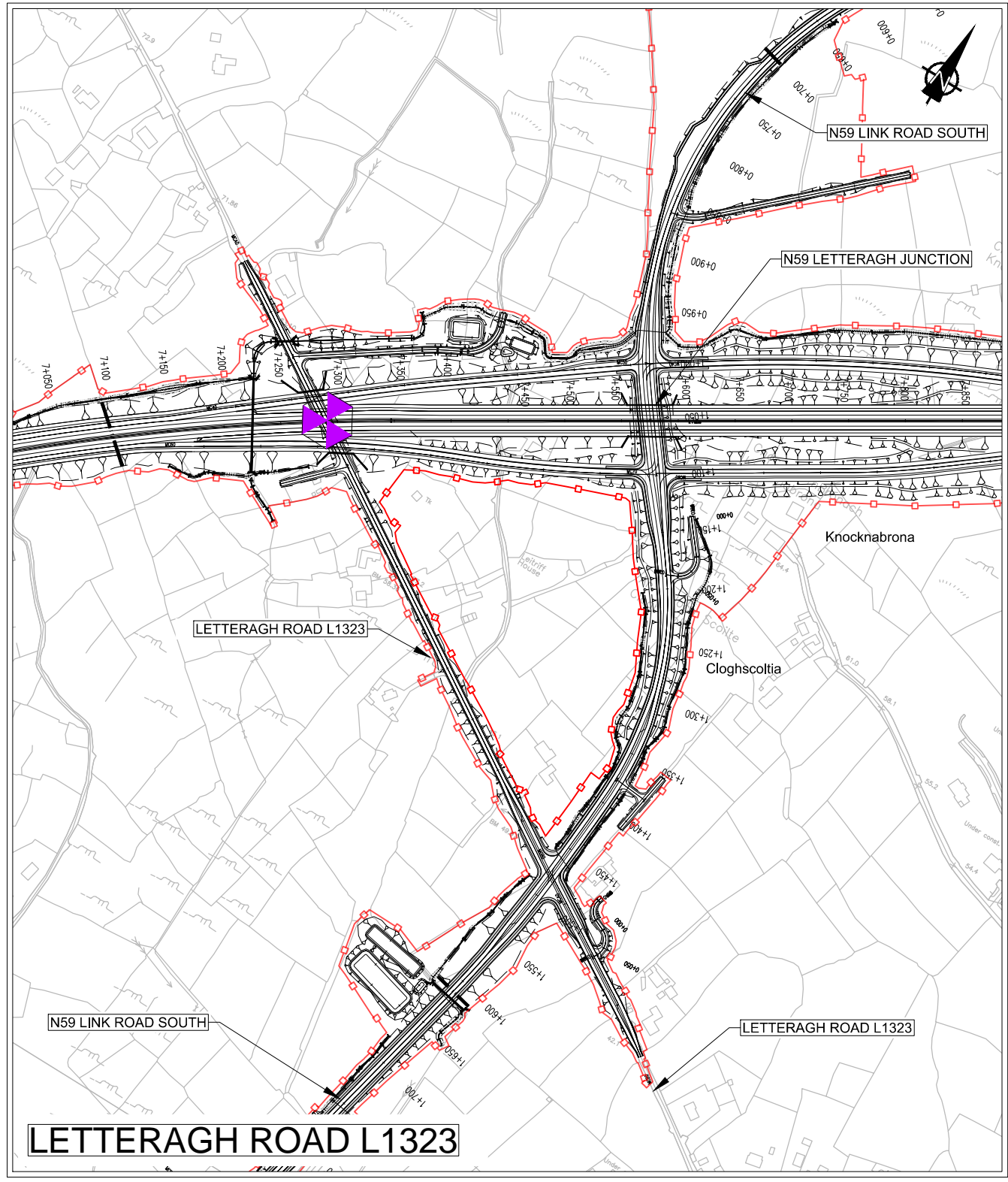

Son áireamh tá sonraíocht Shuirbhíreachtí Ordánais Éireann arna áitirgeadh fust Cheadúnas OSI Uimh. 2010/18CCMA/Comhairle Contae na Gaillimhe. Sírúinn áitirgeadh neamhdídarthe cóipeacht Shuirbhíreachtí Ordánais Éireann agus Rialtas na hÉireann. © Suirbhíreacht Ordánais Éireann, 2010.

© Suirbhíreacht Ordánais Éireann. Gach ceart ar chosaint. Uimhir cheadúnais 2010/18CCMA/Comhairle Contae na Gaillimhe.

Includes Ordnance Survey Ireland data reproduced under OSI Licence number 2010/18CCMA/Galway County Council. Unauthorised reproduction infringes Ordnance Survey Ireland and Government of Ireland copyright. © Ordnance Survey Ireland, 2010.

© Ordnance Survey Ireland. All rights reserved. Licence number 2010/18CCMA/Galway County Council.

**Clients**

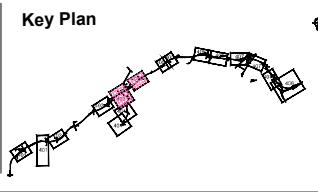

**Consultant**

Corporate House  
City East Business Park  
Ballybrit, Galway, Ireland.

Tel +353 (0)91 460675  
www.N6GalwayCity.ie  
www.arup.ie

**Job Title**  
N6 Galway City Ring Road

**Scale**  
1:5000 @ A3

**Date:**  
February 2018

Issue	Date	By	Chkd	Appd
I1	22/02/2018	AG	GOD	MH

**Drawing Title**  
Traffic Diversions & Road Closures

**Sheet 3 of 8**

**For Information**

Job No	Drawing No	Issue
233985	GCOB-100-D-403	11

- Legend:**
- City Boundary
  - Proposed Development Boundary
  - Proposed Road Development
  - Proposed Temporary Road Diversion
  - Permanent Road Diversion
  - Permanent Road Closure
  - Temporary Road Closure

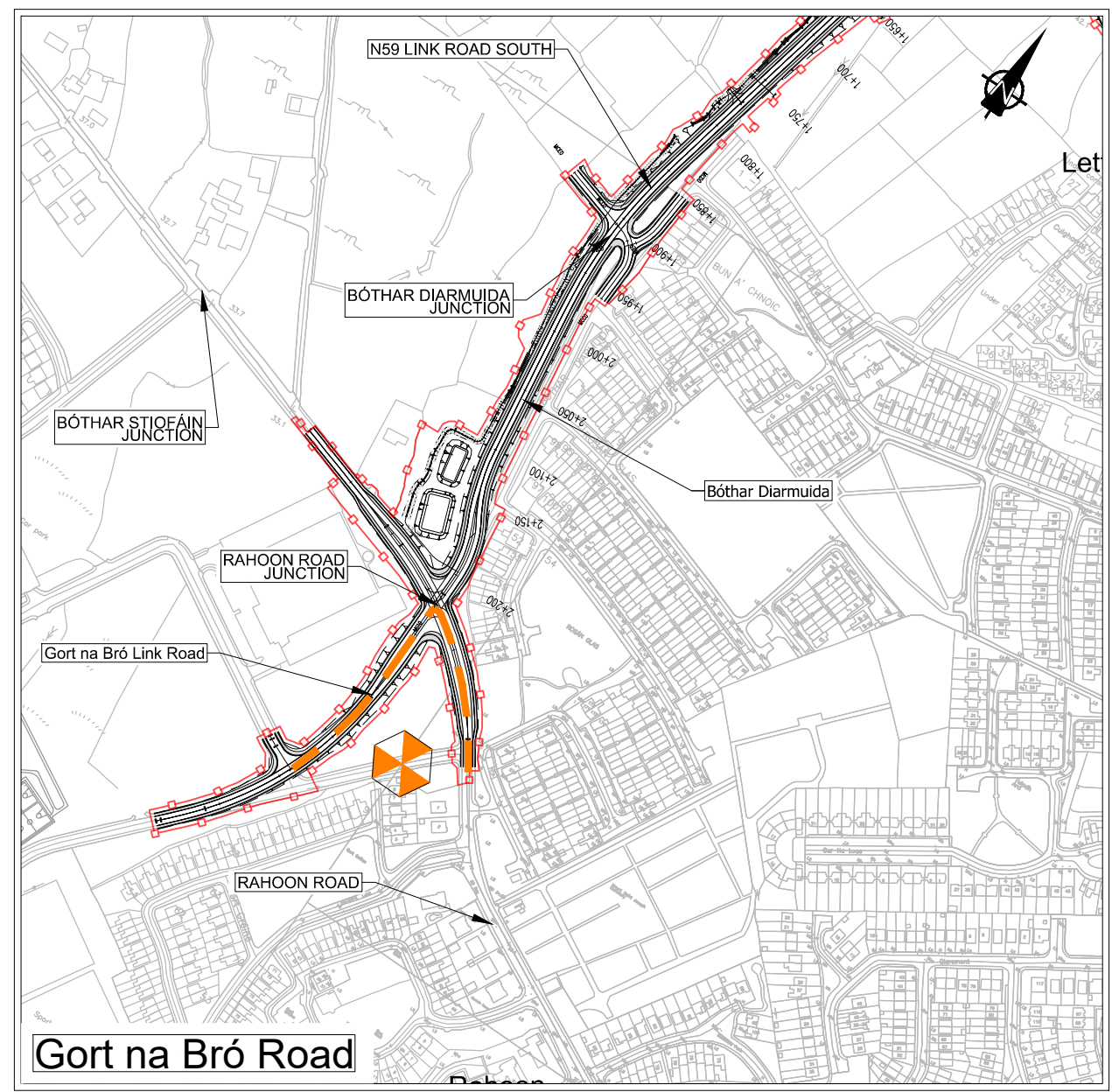
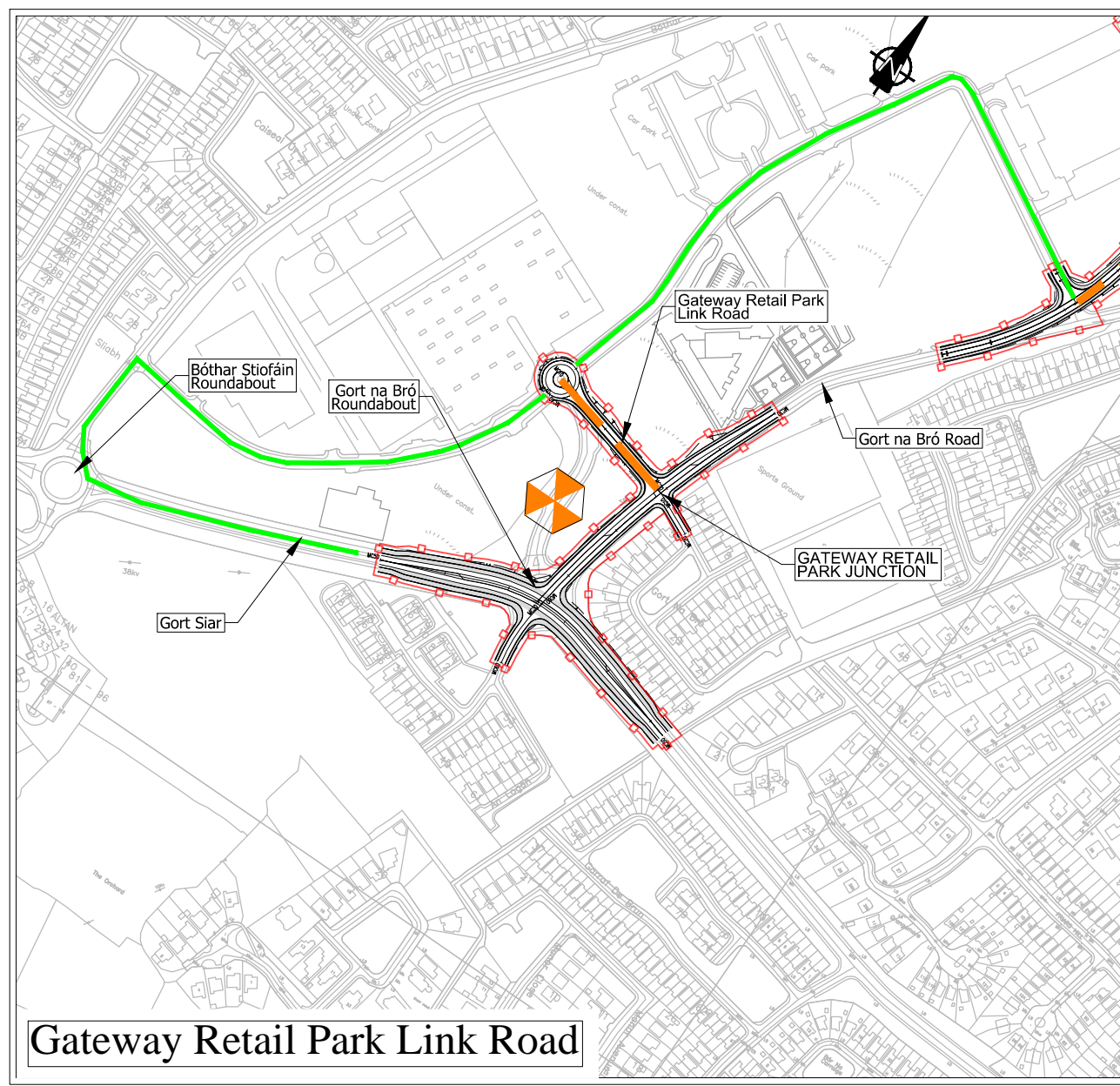

For Continuation see Dwg. No. GCOB-100-D-403

For Continuation see Dwg. No. GCOB-100-D-405

*Son díreámh tá sonraíocht Shuirbhíreachtí Ordánais Éireann arna atáirgeadh fust Cheadúnas OSI Uimh. 2010/18CCMA/Comhairle Contae na Gaillimhe. Sírúisinn atáirgeadh neamhdaraithe cóipeacht Shuirbhíreachtí Ordánais Éireann agus Rialtas na hÉireann. © Suirbhíreacht Ordánais Éireann, 2010.*

© Suirbhíreacht Ordánais Éireann. Gach ceart ar chosaint.  
Uimhir cheadúnais 2010/18CCMA/Comhairle Contae na Gaillimhe.

*Includes Ordnance Survey Ireland data reproduced under OSI Licence number 2010/18CCMA/Galway County Council. Unauthorised reproduction infringes Ordnance Survey Ireland and Government of Ireland copyright. © Ordnance Survey Ireland, 2010.*

© Ordnance Survey Ireland. All rights reserved. Licence number 2010/18CCMA/Galway County Council.

**Clients**

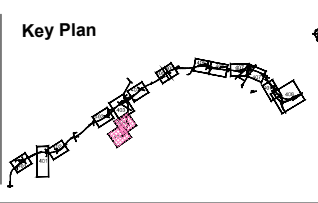

**Consultant**

Corporate House  
City East Business Park  
Ballybrit, Galway, Ireland.

Tel +353 (0)91 460675  
www.N6GalwayCity.ie  
www.arup.ie

**Job Title**  
N6 Galway City Ring Road

**Scale**  
1:5000 @ A3

**Date:**  
February 2018

Issue	Date	By	Chkd	Appd
I1	22/02/2018	AG	GOD	MH







**Drawing Title**  
Traffic Diversions & Road Closures

**Sheet 4 of 8**

**For Information**

Job No	Drawing No	Issue
233985	GCOB-100-D-404	11

**DESIGN REPORT**

- Legend:**
-  City Boundary
  -  Proposed Development Boundary
  -  Proposed Road Development
  -  Proposed Temporary Road Diversion
  -  Permanent Road Diversion
  -  Permanent Road Closure
  -  Temporary Road Closure

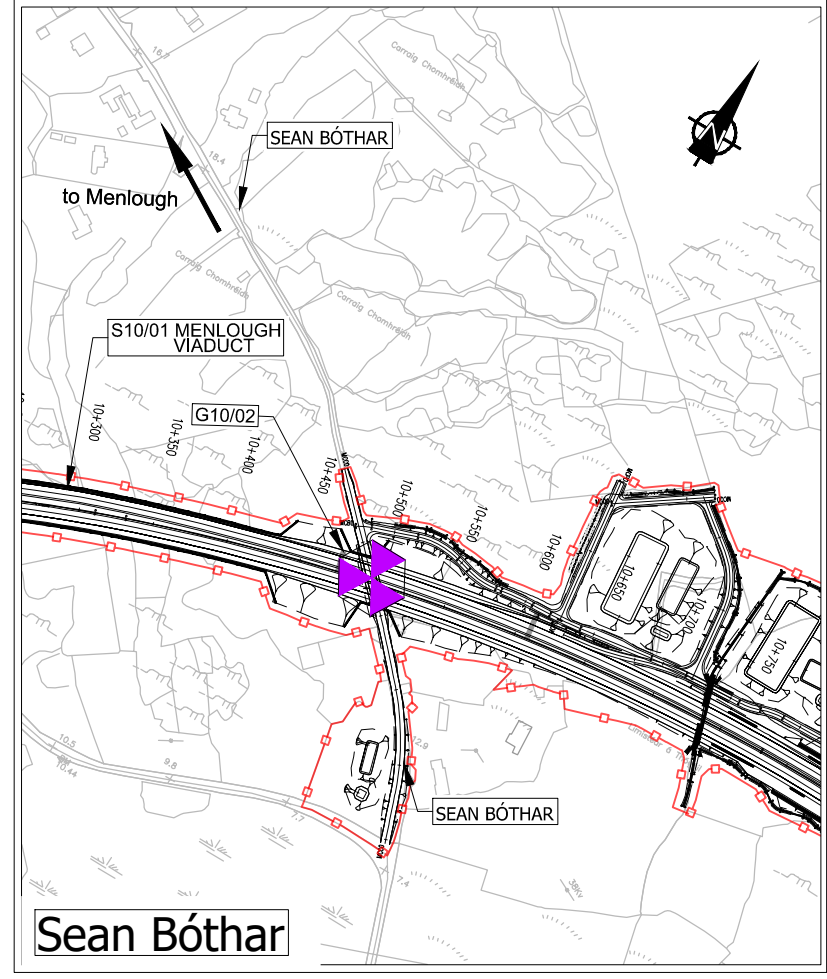
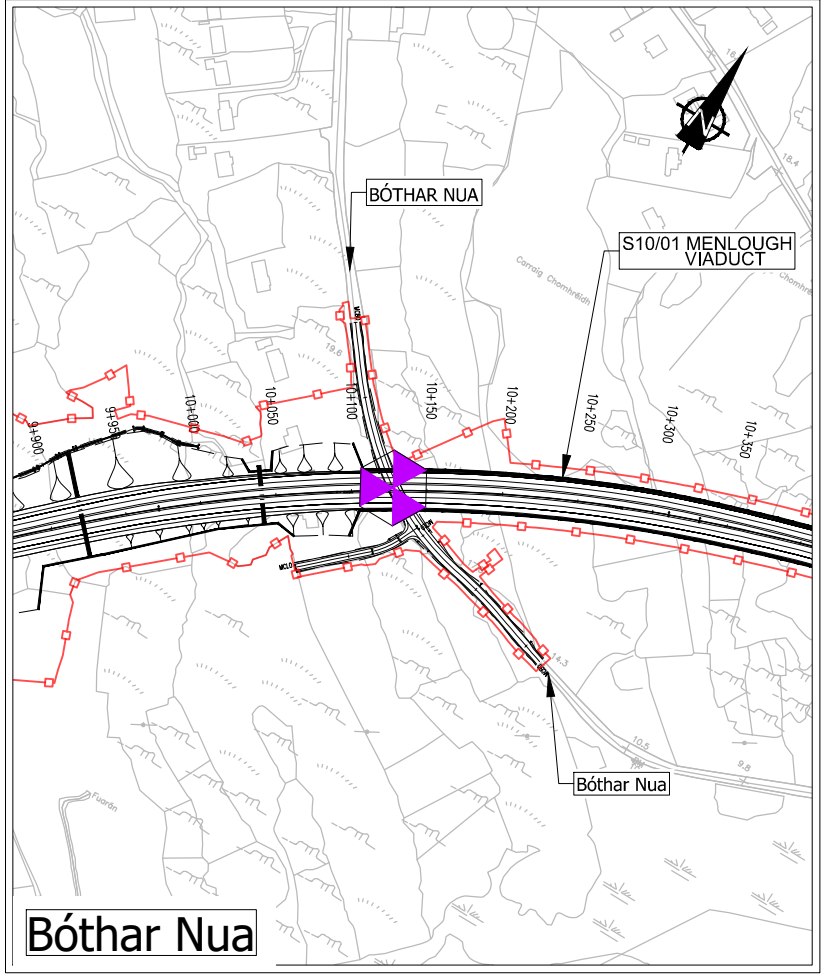

San díreamh tá sonraíocht Shuirbhíreacht Ordánais Éireann arna atáirgeadh fust Cheadúnas OSI Uimh. 2010/18CCMA/Comhairle Contae na Gaillimhe. Sírúinn atáirgeadh neamhdaraithe cóipeacht Shuirbhíreacht Ordánais Éireann agus Rialtas na hÉireann. © Suirbhíreacht Ordánais Éireann, 2010.

© Suirbhíreacht Ordánais Éireann. Gach ceart ar chosaint. Uimhir cheadúnais 2010/18CCMA/Comhairle Contae na Gaillimhe.

Includes Ordnance Survey Ireland data reproduced under OSI Licence number 2010/18CCMA/Galway County Council. Unauthorised reproduction infringes Ordnance Survey Ireland and Government of Ireland copyright. © Ordnance Survey Ireland, 2010.

© Ordnance Survey Ireland. All rights reserved. Licence number 2010/18CCMA/Galway County Council.

**Clients**

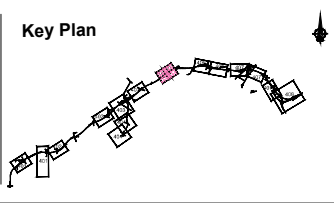
**Consultant**



Corporate House  
City East Business Park  
Ballybrit, Galway, Ireland.

Tel +353 (0)91 460675  
www.N6GalwayCity.ie  
www.arup.ie

**Job Title**  
N6 Galway City Ring Road

**Scale**  
1:5000 @ A3

**Date:**  
February 2018

Issue	Date	By	Chkd	Appd
I2	12/03/2018	AG	GOD	MH
I1	22/02/2018	AG	GOD	MH

**Drawing Title**  
Traffic Diversions & Road Closures

**Sheet 5 of 8**

**Drawing Status**

**For Information**

Job No	Drawing No	Issue
233985	GCOB-100-D-405	12

- Legend:**
- City Boundary
  - Proposed Development Boundary
  - Proposed Road Development
  - Proposed Temporary Road Diversion
  - Permanent Road Diversion
  - Permanent Road Closure
  - Temporary Road Closure

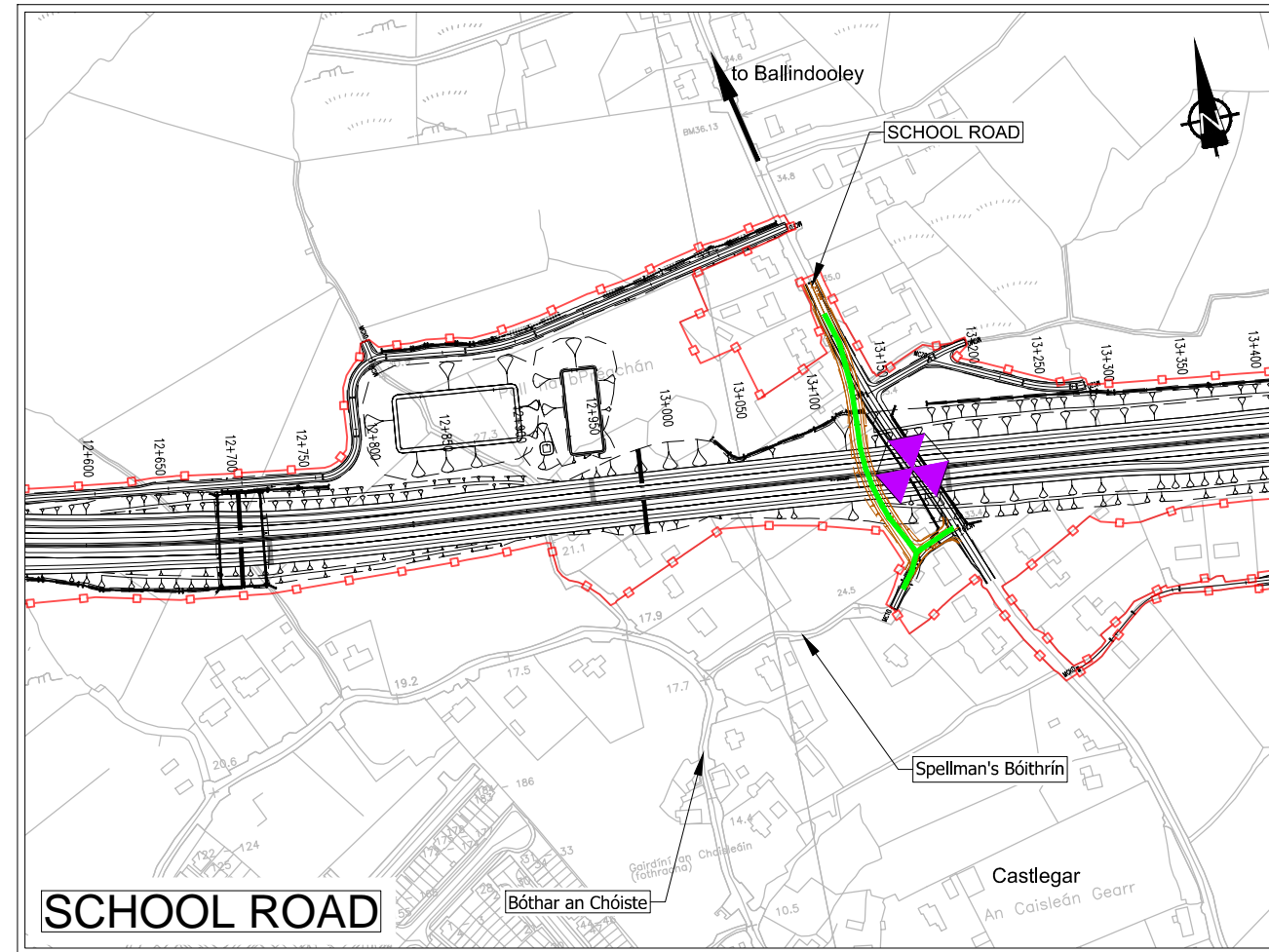
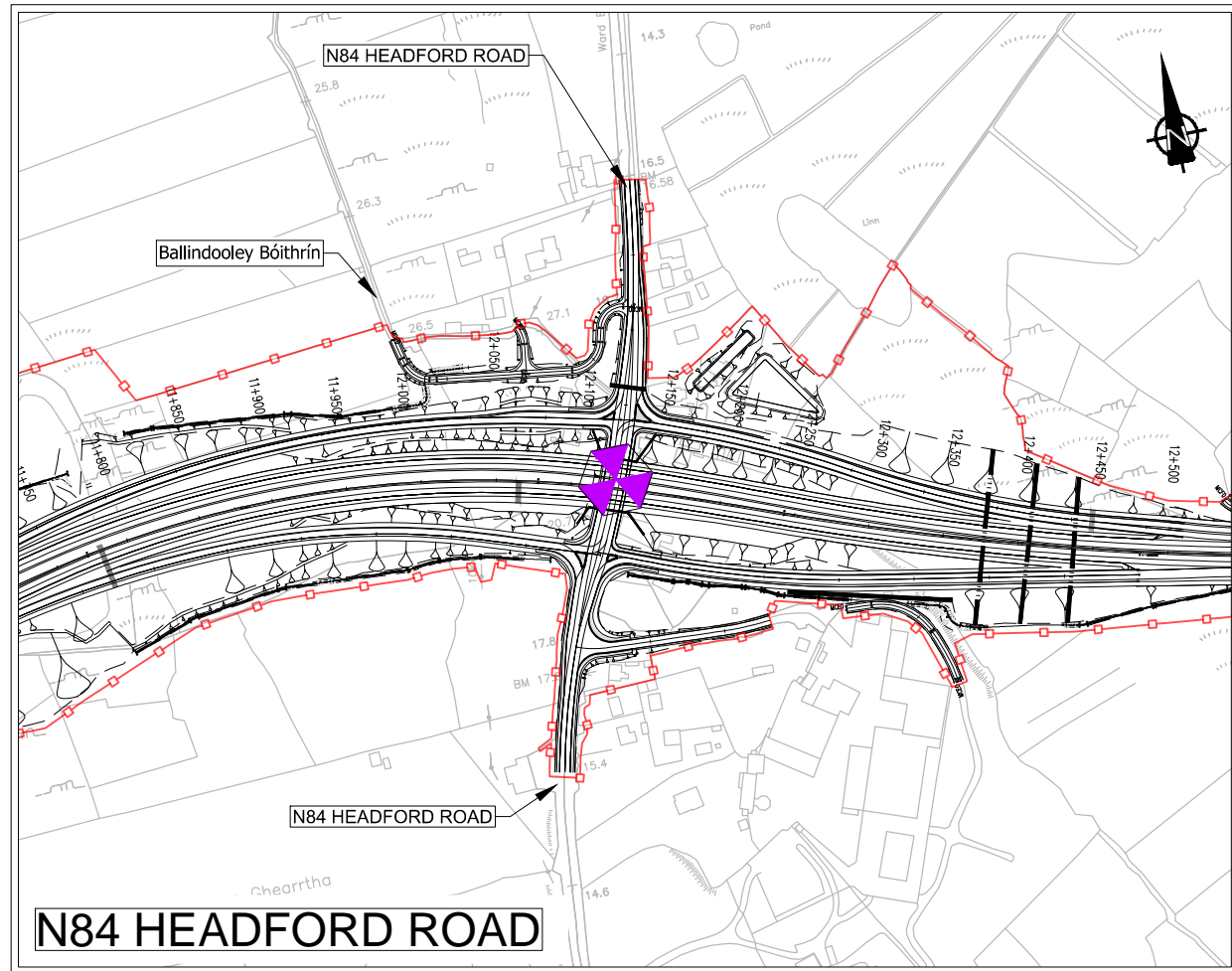

Son díreámh tá sonraíocht Shuirbhíreacht Ordánais Éireann arna atáirgeadh fust Cheadúnas OSI Uimh. 2010/18CCMA/Comhairle Contae na Gaillimhe. Sírtaíonn atáirgeadh neamhdaraithe cóipeacht Shuirbhíreacht Ordánais Éireann agus Rialtas na hÉireann. © Suirbhíreacht Ordánais Éireann, 2010.

© Suirbhíreacht Ordánais Éireann. Gach ceart ar chosaint. Uimhir cheadúnais 2010/18CCMA/Comhairle Contae na Gaillimhe.

Includes Ordnance Survey Ireland data reproduced under OSI Licence number 2010/18CCMA/Galway County Council. Unauthorised reproduction infringes Ordnance Survey Ireland and Government of Ireland copyright. © Ordnance Survey Ireland, 2010.

© Ordnance Survey Ireland. All rights reserved. Licence number 2010/18CCMA/Galway County Council.

**Clients**

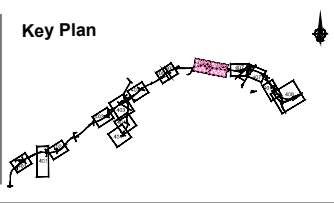

**Consultant**

Corporate House  
City East Business Park  
Ballybrit, Galway, Ireland.

Tel +353 (0)91 460675  
www.N6GalwayCity.ie  
www.arup.ie

**Job Title**  
N6 Galway City Ring Road

**Scale**  
1:5000 @ A3

**Date:**  
February 2018

Issue	Date	By	Chkd	Appd
I1	22/02/2018	AG	GOD	MH

**Drawing Title**  
Traffic Diversions & Road Closures

**Sheet 6 of 8**

**For Information**

Job No	Drawing No	Issue
233985	GCOB-100-D-406	11

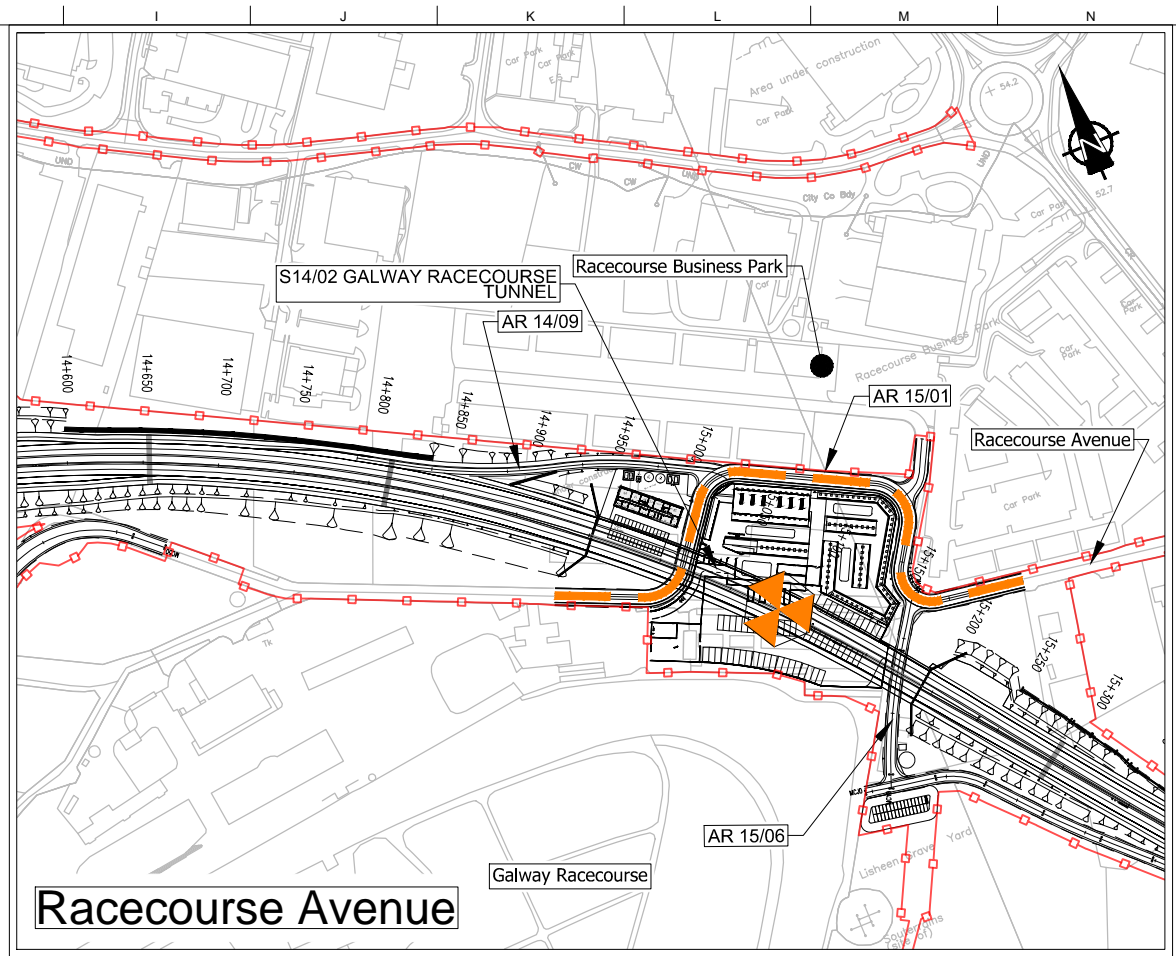
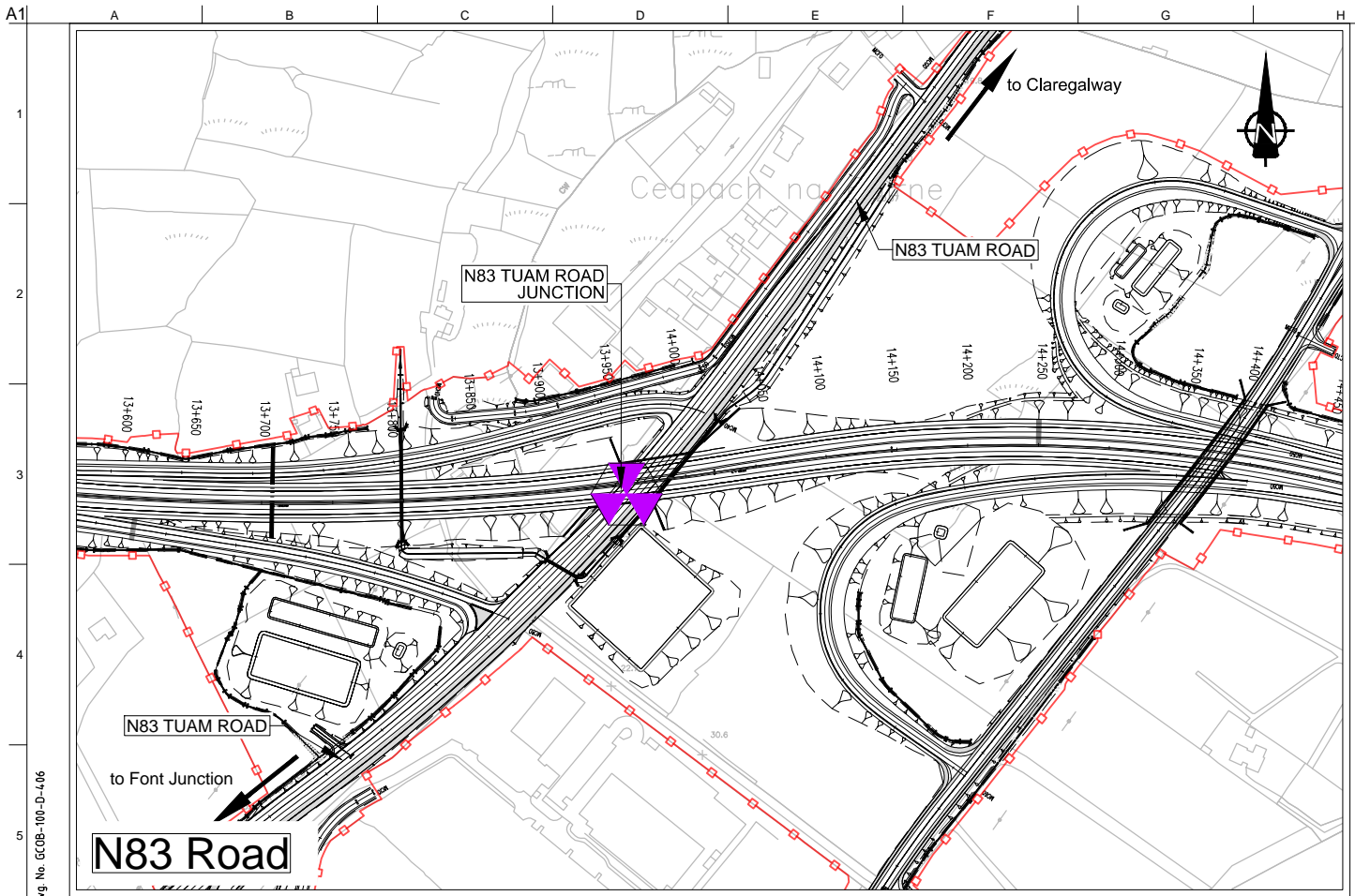

**DESIGN REPORT**

**Legend:**

- City Boundary
- Proposed Development Boundary
- Proposed Road Development
- Proposed Temporary Road Diversion
- Permanent Road Diversion
- Permanent Road Closure
- Temporary Road Closure

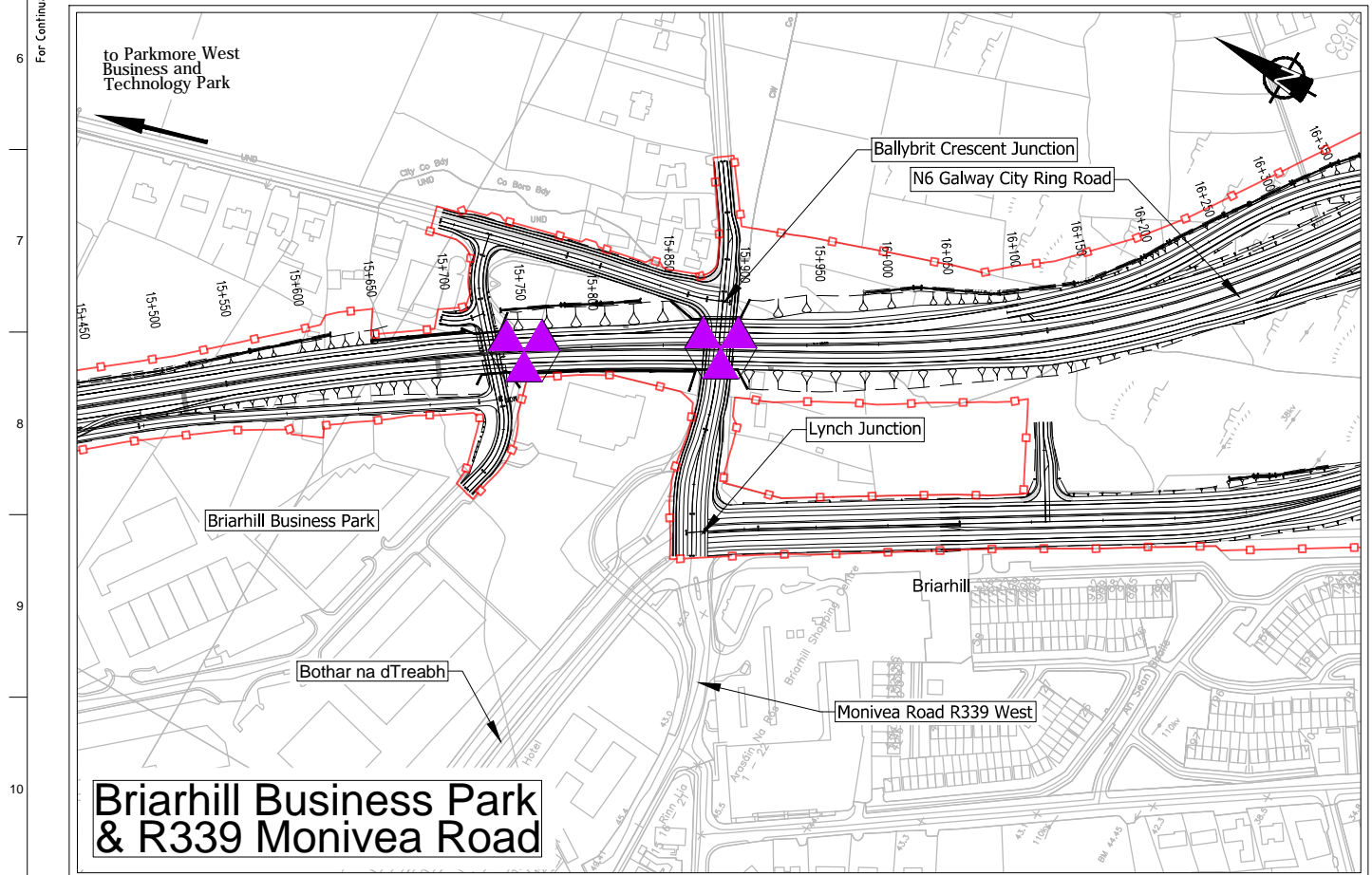

Son áireamh tá sonraíocht Shuirbhíreachtí Ordánais Éireann arna atáirgeadh fust Cheadúnas OSI Uimh. 2010/18CCMA/Comhairle Contae na Gaillimhe. Sírúinn atáirgeadh neamhdhártaíche cóipeacht Shuirbhíreachtí Ordánais Éireann agus Rialtas na hÉireann. © Suirbhíreacht Ordánais Éireann, 2010.

© Suirbhíreacht Ordánais Éireann. Gach ceart ar chosaint. Uimhir cheadúnais 2010/18CCMA/Comhairle Contae na Gaillimhe.

Includes Ordnance Survey Ireland data reproduced under OSI Licence number 2010/18CCMA/Galway County Council. Unauthorised reproduction infringes Ordnance Survey Ireland and Government of Ireland copyright. © Ordnance Survey Ireland, 2010.

© Ordnance Survey Ireland. All rights reserved. Licence number 2010/18CCMA/Galway County Council.

**Clients**

Comhairle Chontae na Gaillimhe  
Galway County Council

**Key Plan**

**Consultant**

**ARUP**

Corporate House  
City East Business Park  
Ballybrit, Galway, Ireland.

Tel +353 (0)91 460675  
www.N6GalwayCity.ie  
www.arup.ie

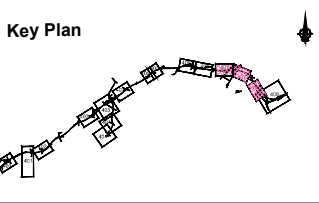

**Job Title**  
N6 Galway City Ring Road

**Scale**  
1:5000 @ A3

**Date:**  
February 2018

Issue	Date	By	Chkd	Appd
I1	22/02/2018	AG	GOD	MH

**Drawing Title**  
Traffic Diversions & Road Closures

**Sheet 7 of 8**

**For Information**

Job No <b>233985</b>	Drawing No <b>GCOB-100-D-407</b>	Issue <b>11</b>
-------------------------	-------------------------------------	--------------------

For Continuation see Dwg. No. GCOB-100-D-407

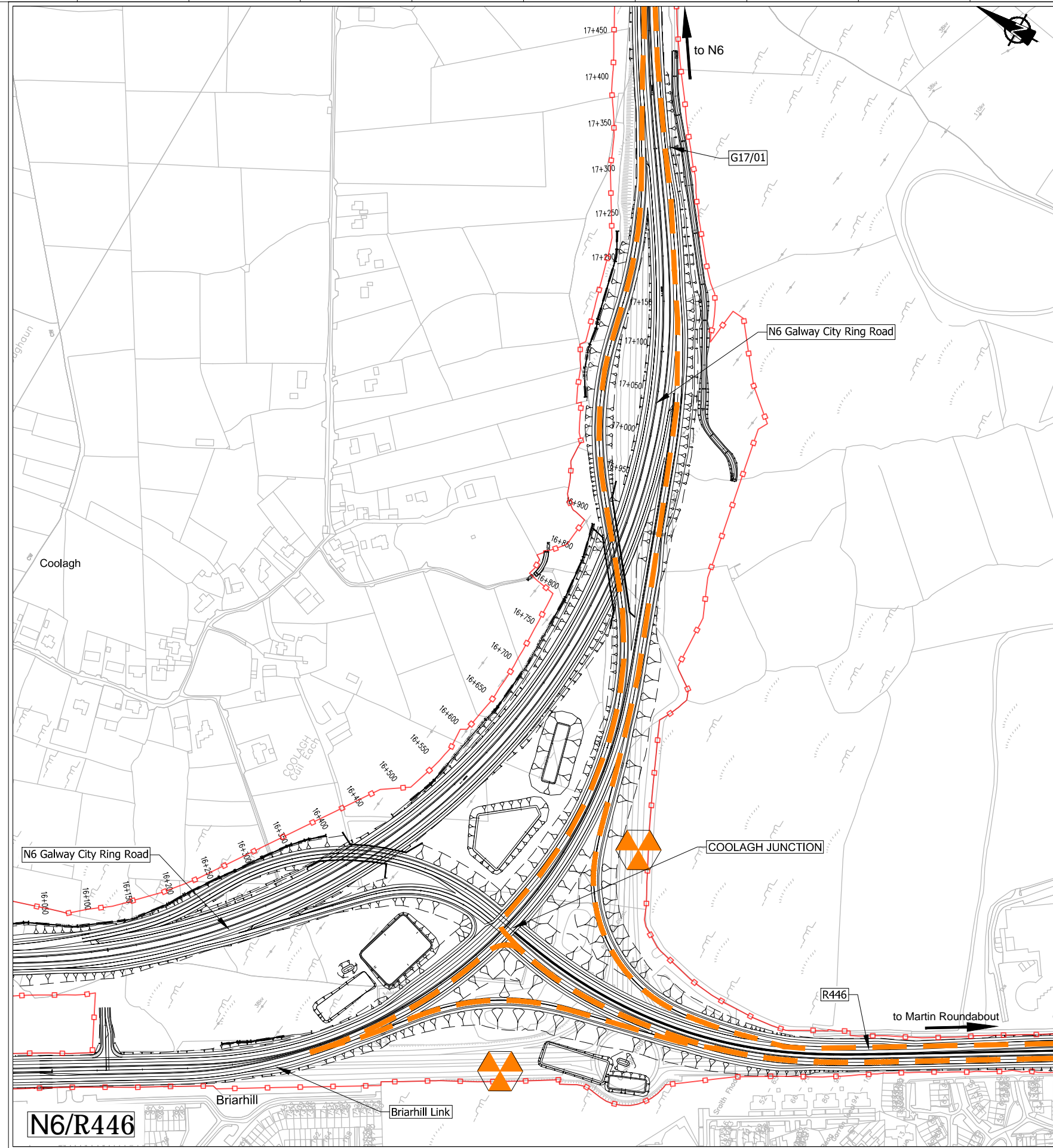

**DESIGN REPORT**

- Legend:**
- City Boundary
  - Proposed Development Boundary
  - Proposed Road Development
  - Proposed Temporary Road Diversion
  - Permanent Road Diversion
  - Permanent Road Closure
  - Temporary Road Closure

*Son áireamh tá sonraíocht Shuirbhíreacht Ordánais Éireann arna áitirgeadh fós Cheadúnas OSI Uimh. 2010/18CCMA/Comhairle Contae na Gaillimhe. Sírtaíonn áitirgeadh neamhdaraithe cóipeacht Shuirbhíreacht Ordánais Éireann agus Rialtas na hÉireann. © Suirbhíreacht Ordánais Éireann, 2010.*

© Suirbhíreacht Ordánais Éireann. Gach ceart ar chosaint.  
Uimhir cheadúnais 2010/18CCMA/Comhairle Contae na Gaillimhe.

*Includes Ordnance Survey Ireland data reproduced under OSI Licence number 2010/18CCMA/Galway County Council. Unauthorised reproduction infringes Ordnance Survey Ireland and Government of Ireland copyright. © Ordnance Survey Ireland, 2010.*

© Ordnance Survey Ireland. All rights reserved. Licence number 2010/18CCMA/Galway County Council.

**Clients**

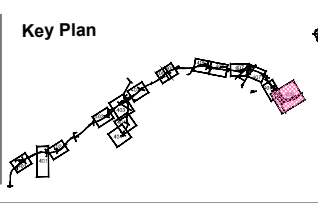
**Consultant**



Corporate House  
City East Business Park  
Ballybrit, Galway, Ireland.

Tel +353 (0)91 460675  
www.N6GalwayCity.ie  
www.arup.ie

**Job Title**  
N6 Galway City Ring Road

**Scale**  
1:5000 @ A3

**Date:**  
February 2018

Issue	Date	By	Chkd	Appd
I1	22/02/2018	AG	GOD	MH

**Drawing Title**  
Traffic Diversions & Road Closures

**Sheet 8 of 8**

**For Information**

Job No	Drawing No	Issue
233985	GCOB-100-D-408	11